

Bouwnr. / Bergingnr.

6 / 44 = 6,0m<sup>2</sup>  
 7 / 43 = 4,5m<sup>2</sup>  
 8 / 1 = 3,7m<sup>2</sup>  
 9 / 2 = 3,7m<sup>2</sup>  
 12 / 3 = 3,7m<sup>2</sup>  
 13 / 4 = 3,5m<sup>2</sup>  
 15 / 5 = 3,7m<sup>2</sup>  
 16 / 6 = 3,7m<sup>2</sup>  
 17 / 7 = 3,7m<sup>2</sup>  
 18 / 8 = 3,5m<sup>2</sup>  
 21 / 9 = 3,7m<sup>2</sup>  
 22 / 10 = 3,7m<sup>2</sup>  
 24 / 42 = 6,1m<sup>2</sup>  
 25 / 47 = 3,8m<sup>2</sup>  
 26 / 11 = 3,7m<sup>2</sup>  
 27 / 12 = 3,5m<sup>2</sup>  
 30 / 13 = 3,7m<sup>2</sup>  
 31 / 14 = 3,7m<sup>2</sup>  
 33 / 40 = 6,5m<sup>2</sup>  
 34 / 45 = 4,0m<sup>2</sup>  
 35 / 15 = 3,7m<sup>2</sup>  
 36 / 16 = 3,5m<sup>2</sup>  
 39 / 17 = 3,7m<sup>2</sup>  
 40 / 18 = 3,7m<sup>2</sup>  
 42 / 38 = 7,2m<sup>2</sup>  
 43 / 46 = 3,9m<sup>2</sup>  
 44 / 19 = 3,7m<sup>2</sup>  
 45 / 20 = 3,5m<sup>2</sup>  
 48 / 21 = 3,7m<sup>2</sup>  
 49 / 22 = 3,7m<sup>2</sup>  
 51 / 69 = 5,5m<sup>2</sup>  
 52 / 70 = 4,0m<sup>2</sup>  
 53 / 23 = 3,7m<sup>2</sup>  
 54 / 24 = 3,7m<sup>2</sup>

Bouwnr. / Bergingnr.

57 / 25 = 3,7m<sup>2</sup>  
 58 / 26 = 3,7m<sup>2</sup>  
 60 / 37 = 5,0m<sup>2</sup>  
 61 / 39 = 4,5m<sup>2</sup>  
 62 / 27 = 3,7m<sup>2</sup>  
 63 / 28 = 3,7m<sup>2</sup>  
 66 / 29 = 3,7m<sup>2</sup>  
 67 / 30 = 3,7m<sup>2</sup>  
 70 / 31 = 3,7m<sup>2</sup>  
 71 / 32 = 3,7m<sup>2</sup>  
 74 / 33 = 3,4m<sup>2</sup>  
 75 / 34 = 3,4m<sup>2</sup>  
 78 / 35 = 4,8m<sup>2</sup>  
 79 / 36 = 4,8m<sup>2</sup>  
 82 / 41 = 4,2m<sup>2</sup>  
 83 / 48 = 3,9m<sup>2</sup>  
 86 / 49 = 3,8m<sup>2</sup>  
 87 / 50 = 3,9m<sup>2</sup>  
 90 / 51 = 3,8m<sup>2</sup>  
 91 / 52 = 3,9m<sup>2</sup>  
 94 / 57 = 3,8m<sup>2</sup>  
 95 / 58 = 3,9m<sup>2</sup>  
 98 / 60 = 4,0m<sup>2</sup>  
 99 / 61 = 3,9m<sup>2</sup>  
 102 / 59 = 3,8m<sup>2</sup>  
 103 / 62 = 4,2m<sup>2</sup>  
 106 / 63 = 4,0m<sup>2</sup>  
 107 / 64 = 3,9m<sup>2</sup>  
 114 / 72 = 3,9m<sup>2</sup>  
 115 / 71 = 4,0m<sup>2</sup>  
 122 / 68 = 3,8m<sup>2</sup>  
 123 / 67 = 3,6m<sup>2</sup>  
 130 / 66 = 3,7m<sup>2</sup>  
 131 / 65 = 3,4m<sup>2</sup>

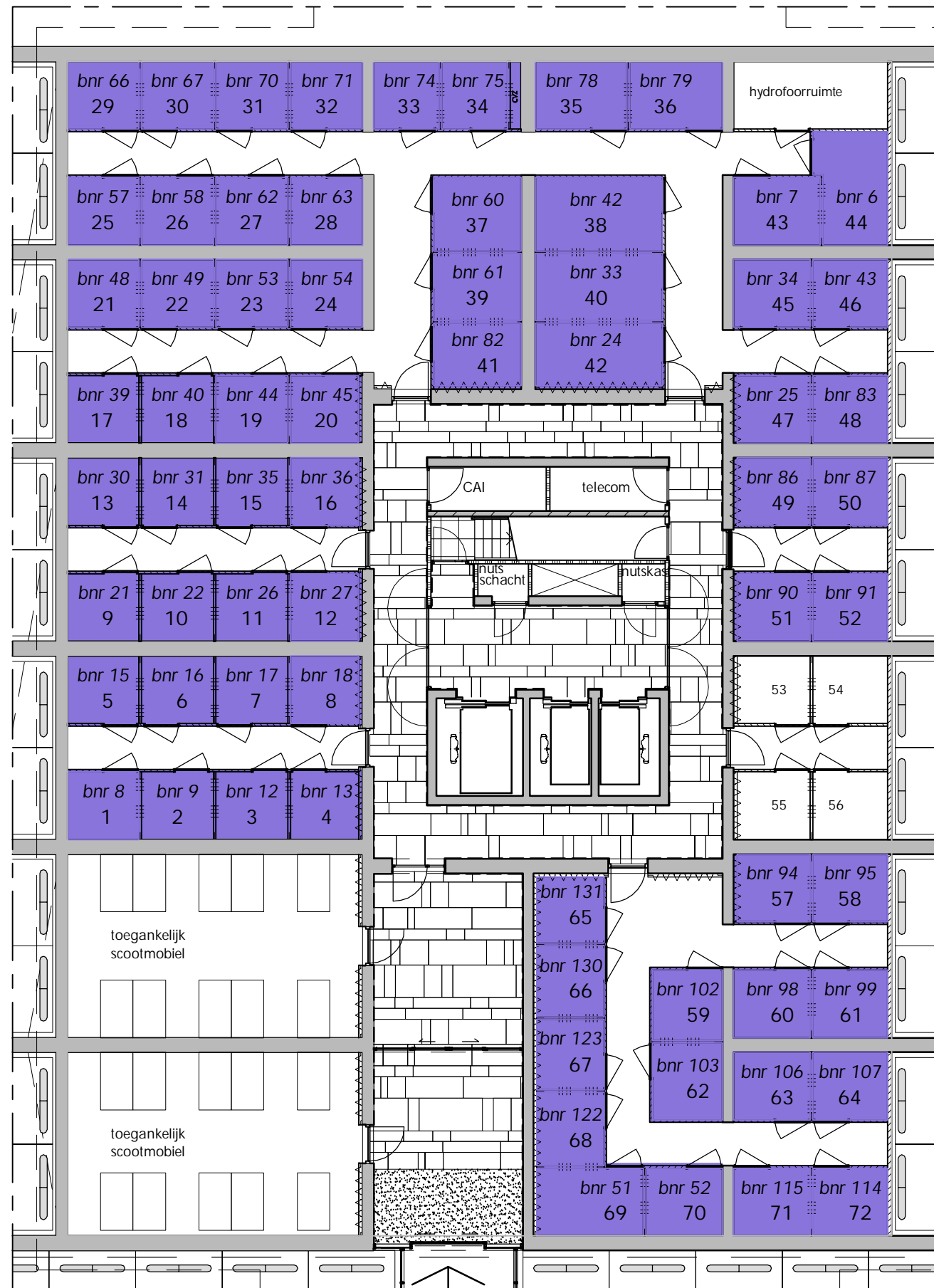

Bergingen MDG

**bnr 91**  
**52**

Bouwnummer 91  
Bergingsnummer 52

**HUUR**

overzicht bergingen  
Maasdelta Groep  
verdieping:  
kelder -1



schaal 1:150  
gew. F: d.d. 01-04-2020

**DAM**  
&  
**PARTNERS**  
ARCHITECTEN

aan deze tekeningen kunnen geen rechten worden ontleend